

SLIDING MAIN GATE MAIN GATE  
SCALE 1:50

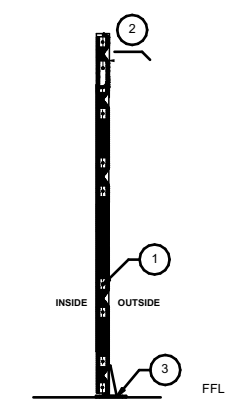

SECTION B-B

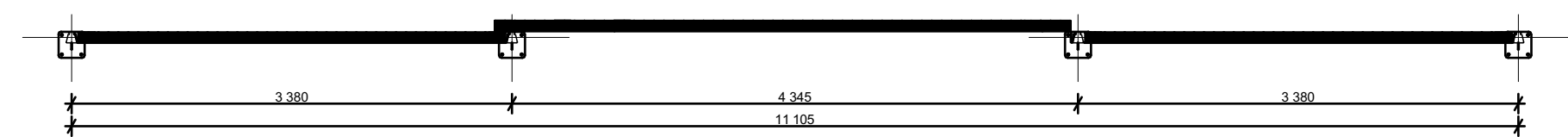

SLIDING MAIN SECTION A-A  
SCALE 1:50

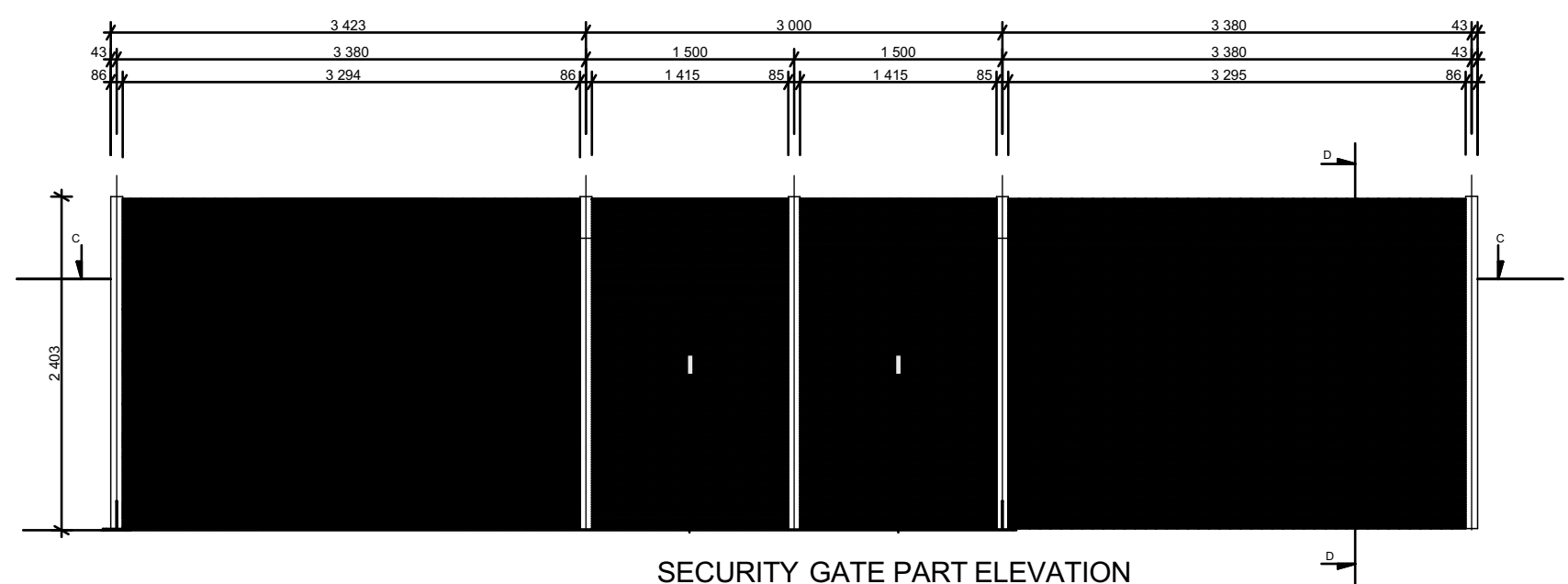

SECURITY GATE PART ELEVATION  
SCALE 1:50

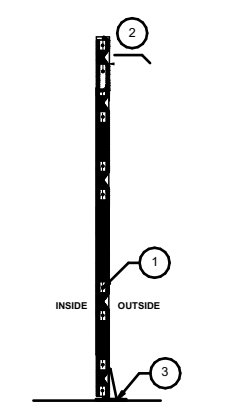

SECTION D-D

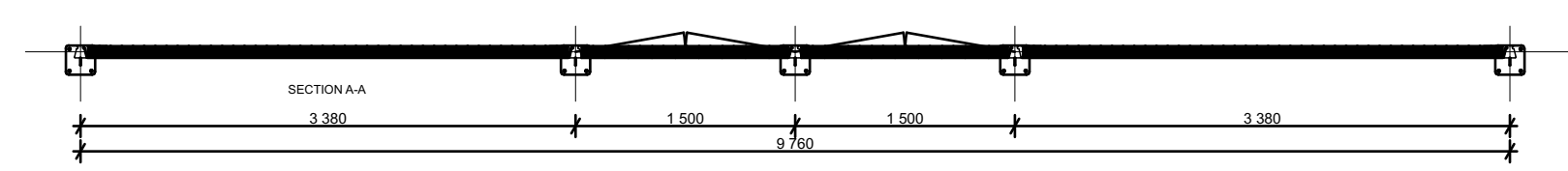

SECURITY GATE SECTION C-C  
SCALE 1:50

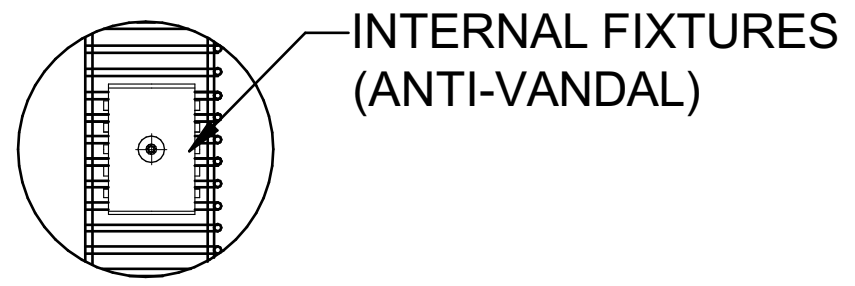

DETAIL 1

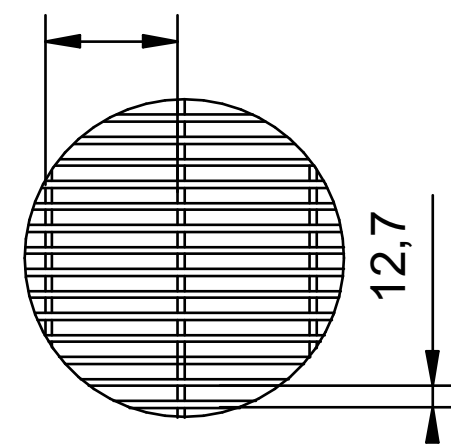

DETAIL 2

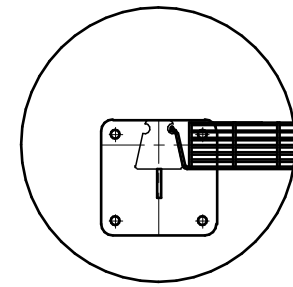

DETAIL 3

- PANEL CLEARVU MESH PANELS 3305mm WIDE x 1800mm HIGH GALVANIZED Ø3mm WIRE WITH APERTURE SIZE (CENTERS) @ 76.2mm x 12.7mm. PANEL FORMATION: PANEL REINFORCED WITH 4 x 50mm DEEP 'V' FORMATION HORIZONTAL RECESSED BANDS (RIGIDITY), 2 x 75mm 70° FLANGES ALONG SIDES (INTERNAL FIXTURES - ANTI VANDAL, ALLOWING FOR FLUSH POST AND PANEL FINISH, 48 LINE WIRE SECURE CONNECTION, LOCKING RECESS MECHANISM ) AND 2 x 30° FLANGES ALONG TOP AND TOE. (ARROW - STRAIGHT EDGES, INTEGRATED ANGLE). COATING: MESH GALVANIZED, THEN MARINE FUSION BOND COATED.  
  
(PATENTS AND DESIGN REGISTRATIONS APPLY)
- POST COCHRANE TAPER LOCKING POST 85mm x 45mm x 85mm, THEN SEALED WITH UV STABILIZED POLYMER CAP. COATING: GALVANIZED, THEN MARINE FUSION BOND COATED.
- CLAMPS BOLT COMB CLAMPS. COATING: GALVANIZED, THEN MARINE FUSION BOND COATED.
- BASE PLATE BASE PLATE, WITH 4 x HOLES TO ACCOMMODATE FIXING, WITH GUSSETS. COATING: GALVANIZED, THEN MARINE FUSION BOND COATED.
- CRANKED TAPER POST CRANKED AT 45°. POST COATING: GALVANIZED, THEN MARINE FUSION BOND COATED.

Revisions			
Date	Rev.	Description	By

THIS DRAWING IS COPYRIGHT AND IS TO BE RETURNED ON COMPLETION OF THE CONTRACT. ALL DIMENSIONS TO BE CHECKED BY THE CONTRACTOR ON SITE. FIGURED DIMENSIONS TO BE TAKEN IN PREFERENCE TO SCALING THE DRAWING. ANY DISCREPANCIES OR VARIATION REQUIREMENTS NOTICED ON SITE TO BE REPORTED TO THE PROJECT MANAGERS./ ARCHITECT

Consultants



Unit 25, Willowbrook Office Park  
Van Hoof Street, Rummig  
Johannesburg, 1724  
Tel: 011 432 6640  
Cell: 076 175 9452  
Fax: 011 432 6641  
studio@lbrconsulting.co.za

Client

Project details

Drawing title

Drawn by	Checked by	Date
Scale	Paper Size	Sheet No.
Drawing number		